

Other 050-0100 Two-Rotor Latches

DESIGNED FOR:

- Medium to heavy weight doors for on or off-highway applications
- Applications where it is desirable to have the release mechanism in-line with the latch (050-0103 Two-Rotor Latch 2-Position Intertrip)
- Applications where it is desirable to provide additional support to the trip lever (050-0107 Two-Rotor Latch With Coaxial Trip)
- Applications where it is desirable to have a single position rotary latch (050-0110 Two-Rotor 1-Position Latch)
- Door thicknesses of 1-7/8" or greater (47.6mm)
- Door weights of 50-200 lbs. (23-91kg)
- Door seal pressures of 50-150 lbs. (23-68kg) (suggested for best results)

AVAILABLE:

- In left or right hand configurations
- With (4) 1/4-20 UNC, M6 X 1 threaded axles or .286" (7.3mm) diameter "thru" axles
- With trip lever options
- With a torsion return spring (050-0107)
- Straddle mount option (050-0110)

INTERNAL LUBRICATION:

- Oven-cured dry lubricant is applied at factory on all critical moving parts

INSTALLATION:

- Four 1/4-20 UNC grade 5 or M6 X 1 class 8.8 or better fasteners are required (not included)
- Tighten to the fastener manufacturers' recommended torque value, however, do not exceed 120 in-lbs. (13.3 N-m)
- Fastener mounting holes diameter should not exceed .281 (7.1 mm)

FINISH:

- Zinc plated, clear chromate steel components

MATERIAL:

- Internal latch components: heat treated, smooth edge stamped steel
- Case halves: high strength steel
- Springs: non-corrosive stainless steel

Part Number	Description
050-0103	Two-Rotor Latch 2-Position Intertrip
050-0107	Two-Rotor Latch With Coaxial Trip
050-0110	Two-Rotor Single-Position Latch

CAUTION: Single position, double rotor latches do not comply with FMVSS 206 requirements.

Latch with 2 position rotors complies with FMVSS 206 in primary and secondary latching positions when tested with approved TriMark FMVSS 206 compliant striker bolts in accordance with SAE J839

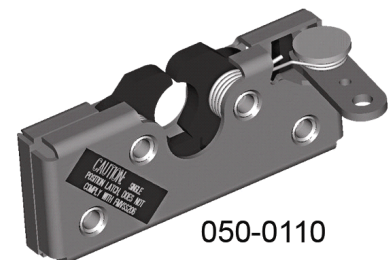
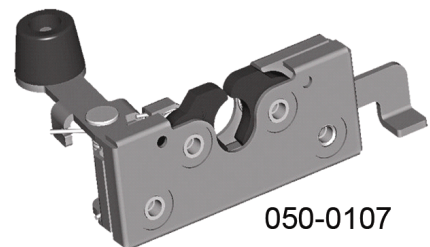
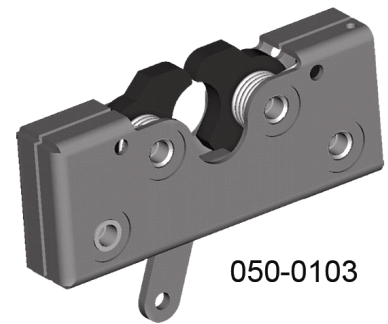

050-0200 Slimline Rotary Latch

This compact single rotor latch is designed for light to medium applications for on or off-highway entrance doors, compartments and access panels. It features a variety of trip levers and mounting axles for ease of mounting and applications and is FMVSS 206 compliant.

- Door weights up to 75 lbs. (37 kg)
- Door seal pressures of 20-25 lbs. (9-11 kg) recommended for best results (not to exceed 50 lbs. [23 kg])
- Visible surface installation or concealed installation

AVAILABLE:

- Left or right hand configurations (left hand shown)
- With standard .265" (6.7mm) diameter "thru" axles as shown, 1/4-20 UNC threaded axles or M6 X 1.0 threaded axles

FINISH:

- Zinc plated, clear chromate steel components
- Stainless steel

MATERIAL:

- Internal latch components: heat treated smooth edge stamped steel
- Springs: non-corrosive stainless steel
- Case halves: high strength steel

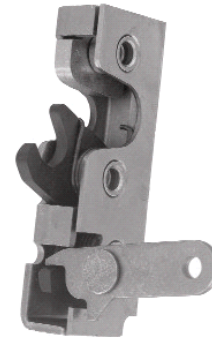

INSTALLATION:

- Three 1/4-20 UNC grade 5-type or M6 X 1 class 8.8 or better fasteners are recommended
- Vertical mounting with support ramp at top is required for proper alignment and subsequent engagement of locking pawl and striker bolt
- Tighten to the fastener manufacturers' recommended torque value, however, do not exceed 120 in-lbs. (13.3 N-m)

INTERNAL LUBRICATION:

- Oven-cured dry lubricant is applied on all critical moving parts

U.S. Patent No. 7,156,430

U.S. Patent No. 7,320,488

Two position rotor latches comply with FMVSS 206 in primary and secondary latching positions when tested with approved TriMark striker bolts in accordance with SAE J839.

